

## Steering Column Shaft — Lower

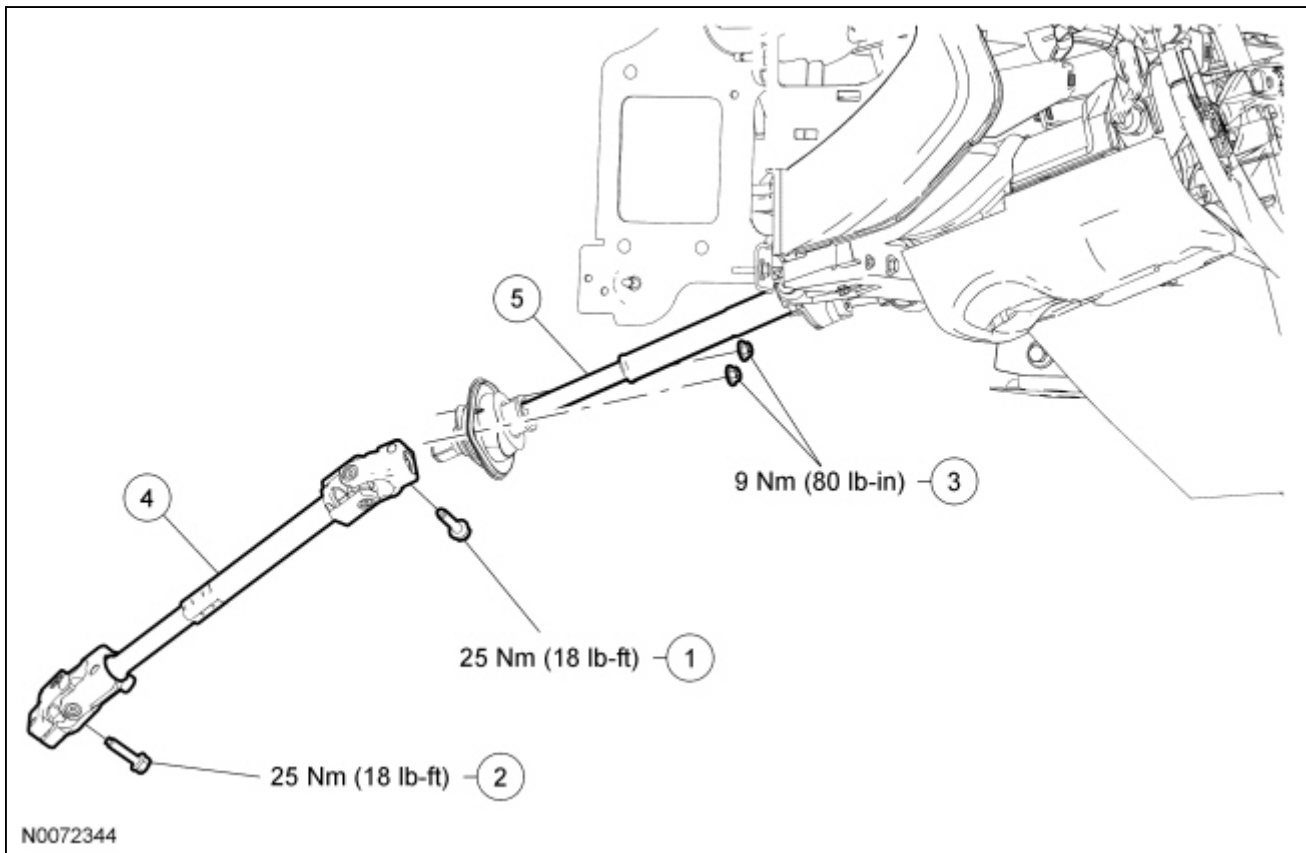

Item	Part Number	Description
1	W704980	Lower steering column shaft-to-upper steering column shaft bolt
2	W704980	Steering column coupling-to-steering gear bolt
3	W707137	Dash boot bearing nuts (2 required)
4	3C662	Lower steering column shaft
5	3E751	Upper steering column shaft

### Removal and Installation

**NOTICE:** Do not allow the steering column to rotate while the steering column shaft is disconnected or damage to the clockspring may result. If there is evidence that the steering column shaft has rotated, the clockspring must be removed and recentered. For additional information, refer to [Section 501-20B](#).

1. With the vehicle in NEUTRAL, position it on a hoist. For additional information, refer to [Section 100-02](#).
2. Remove and discard the lower steering column shaft-to-upper steering column shaft bolt.
  - To install, tighten the new bolt to 25 Nm (18 lb-ft).
3. Remove and discard the steering column coupling-to-steering gear bolt.
  - To install, tighten the new bolt to 25 Nm (18 lb-ft).
4. Remove the 2 dash boot bearing nuts.
  - To install, tighten to 9 Nm (80 lb-in).

5. Collapse the upper steering column shaft slightly and disconnect it from the lower steering column shaft.
  6. Remove the lower steering column shaft.
  7. To install, reverse the removal procedure.
-